

# 14.4kW 208V 3PH Monitored Per-Outlet PDU - LX Interface, Gigabit, 18 Outlets, 50A CS8365C Input, LCD, 1.8 m Cord, 0U 1.8 m Height, TAA

MODEL NUMBER: PDU3EVNR6H50A

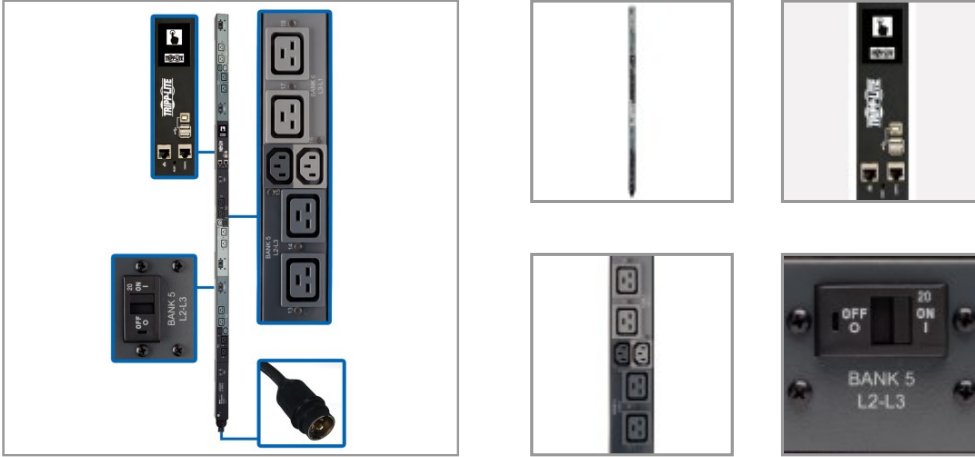

3-phase PDU allows real-time remote monitoring of individual outlets to help you track power consumption trends and detect problems early.

## Features

**14.4kW 3-Phase PDU Distributes and Monitors Network-Grade Power** This monitored PDU provides real-time remote monitoring of voltage and load levels via its built-in network interface. Ideal for your data center, computer room or high-density network closet, the PDU3EVNR6H50A features six C13 and 12 C19 208V outlets in six breakered load banks, which distribute AC power to rack equipment. Plug-lock insert sleeves are included to prevent equipment cables from becoming accidentally dislodged.

**Monitored Per-Outlet PDU Lets You Keep Track of Power Consumption in Real Time** Not only can you remotely monitor voltage and frequency, but the PDU3EVNR6H50A also allows metering of per-phase input current, as well as output current per bank and per outlet. Banks can be individually monitored to ensure proper load balance and prevent downtime. Monitoring each outlet allows you to study power consumption trends for each connected device. This helps you detect hardware problems and network traffic bottlenecks, as well as compare power usage among various devices.

**Built-In GbE-Capable Network Management Card Allows Remote Access 24/7** The built-in WEBCARDLX with the latest version of PowerAlert Device Manager firmware (PADM20) provides enhanced remote management capabilities, including customizable dashboard graphs to fit user preferences. The PADM20 upgrade and PowerAlert Element Manager (PAEM) software form a powerful tool for expanding maintenance functions in large installations, including firmware update checks and backup and restoration of device configurations.

**Color Touchscreen LCD Gives You Important Data at a Glance** An easy-to-navigate color touchscreen LCD reports network data, including IP address, input current level per phase, and output current per load bank and per outlet with  $\pm 1\%$  billing-grade accuracy. It also generates a unique QR code to allow read-only access to the PDU via PowerAlert® Device Manager. If an EnviroSense2 module is connected, the LCD also displays status and environmental data, including temperature and humidity.

**Easy to Install Vertically in an EIA-Standard 19 in. Rack** The 70-inch 0U rack PDU (rPDU) mounts vertically using the included toolless mounting buttons or the included rack-mounting brackets. Spare buttons are also included. Use the included PDUMVROTATEBRKT kit to install the PDU with outlets facing the rear for better airflow or equipment access. A six-foot cord with a Hubbell 50A CS8365C 208V input connects the PDU to a compatible AC power source, generator or protected UPS.

## Highlights

- Advanced remote capabilities include outlet-level current monitoring in real time
- 6 C13 and 12 C19 208V outlets distribute AC power to connected equipment; Compatible with Eaton Tripp Lite power cords.
- Pre-installed GbE-capable WEBCARDLX with latest version of PADM20 for enhanced remote management
- Color touchscreen LCD provides current levels, environmental data and network info
- Installs in 0U of rack space in standard 19 in. racks using included mounting hardware

## Applications

- Power mission-critical rack equipment in a data center, computer room or high-density network closet in a government, commercial or industrial facility
- Monitor power loads from various computers, switches, servers and other networking equipment
- Study power consumption trends over time for equipment connected to each individual outlet

## Package Includes

- PDU3EVNR6H50A 14.4kW 3-Phase Monitored Per-Outlet PDU
- Built-in LX Platform interface
- Configuration cable
- (18) Plug-lock insert sleeves
- Rack-mounting hardware
- Spare mounting buttons
- PDUMVROTATEBRKT mounting bracket accessory
- Owner's manual



Powering Business Worldwide

TRIPP LITE  
SERIES

**TAA-Compliant for GSA Schedule Purchases**The PDU3EVNR6H50A is compliant with the Federal Trade Agreements Act (TAA), which makes it eligible for GSA (General Services Administration) Schedule and other federal procurement contracts.

## Specifications

OVERVIEW	
UPC Code	037332242259
PDU Type	Monitored
INPUT	
Input Phase	3-Phase
PDU Input Voltage	208
Recommended Electrical Service	Three-phase 50A 208V service
Maximum Input Amps	40
Maximum Input Amps Details	Agency de-rated to 45A continuous
PDU Plug Type	(1) HUBBELL CS8365C 50A
Input Cord Length (ft.)	6
Input Cord Length (m)	1.83
OUTPUT	
Output Capacity Details	14.4kW (208V) total capacity; 23A max per output phase (L1-L2, L2-L3, L3-L1); 20A max per breakered outlet bank; 16A max per C19 outlet; 12A max per C13 outlet
Frequency Compatibility	50 / 60 Hz
Output Receptacle Details	Compatible with Eaton Tripp Lite Power Cords
Output Receptacles	(6) C13; (12) C19
Output Nominal Voltage	208V
Overload Protection	Six 20A circuit breakers, one per output load bank
USER INTERFACE, ALERTS & CONTROLS	
Reported Load Segments	Reports input current per phase (L1, L2, L3) and output current for each breakered load bank (23A combined max per banks B1+B4, B2+B5, B3+B6); 20A Max per banks B1-B6); Outlets are color-coded and labeled for phase and load bank identification; L1-L2 feeds black outlets (B1 & B4); L2-L3 feeds dark-gray outlets (B2 & B5); L3-L1 feeds light-gray outlets (B3 & B6)
Front Panel LCD Display	Touchscreen LCD reports NETWORK DATA (IP address, Subnet Mask, Gateway, MAC Address, Device Name, Model, Serial Number), INPUT PHASE DATA (Amperage, Wattage, Voltage per phase, plus Unbalance percentage), LOAD BANK DATA (Amperage, Wattage, Voltage per load bank, plus total PDU output in watts), OUTLET DATA (Amperage, Wattage per outlet), CONFIGURATION DATA (Listing of current configuration settings), ENVIRONMENTAL DATA (Reports data and status of E2 sensor modules; Sensor options are available for temperature and humidity, plus input and output dry contacts), MOBILE ACCESS (Generates a unique QR code to view reported PDU details on a mobile device)
Switches	LX Platform Interface: Recessed reset switch for interface reboot and factory reset



Powering Business Worldwide

TRIPP LITE  
SERIES

LED Indicators	One LED for each output receptacle offers power availability information: GREEN (Power ON, load bank capacity <80%), YELLOW (Power ON, load bank capacity >80%), RED (Undervoltage), RED FLASHING (Power OFF/breaker trip), LED OFF (Power OFF); Network Interface LEDs report Network Activity (Green, Flashes for network activity), Link/Network Speed (Yellow, On steady for any speed).
Current Measurement Accuracy (Amps)	+/-1%
Voltage Measurement Accuracy (Volts)	+/-1%
Power Measurement Accuracy (Watts)	+/-1%
<b>SURGE / NOISE SUPPRESSION</b>	
Automatic Shut-Off	No
<b>PHYSICAL</b>	
Material of Construction	Metal
Rack Height	0U
Form Factors Supported	Vertical rackmount installation supported with included mounting brackets; supports toolless mounting in button-mount compatible racks
PDU Form Factor	Vertical (0U)
Shipping Dimensions (hwd / in.)	6.89 x 9.65 x 75.87
Shipping Weight (kg)	12.28
Unit Dimensions (hwd / in.)	70.000 x 2.170 x 2.860
Unit Dimensions (hwd / cm)	177.8 x 5.51 x 7.26
Unit Weight (lbs.)	14.13
Unit Weight (kg)	6.41
<b>ENVIRONMENTAL</b>	
Operating Temperature Range	32° to 104°F (0° to 40°C)
Storage Temperature Range	-22° to 140°F (-30° to 60°C)
Relative Humidity	5% to 95% non-condensing
Operating Elevation	0-10000 ft. (0-3000 m)
<b>COMMUNICATIONS</b>	
PowerAlert Software	LX Platform Interface: PowerAlert Device Manager
Communications Cable	USB B-to-USB A Configuration/Console Access cable
Network Monitoring Port	RJ45 Network port, RJ45 Config/Console Access port; 2x USB A ports supports a variety of Envirosense2 environmental and control modules. See Accessories>Management Hardware section for more information about these modules. USB B port (Configuration & Console Access)
SNMP Compatibility	SNMP V1, V2c, V3
Network Compatibility	10 Mbps; 100 Mbps (Fast Ethernet); 1 Gbps (Gigabit)
Communications Interface	Pre-installed network card; RS-232; USB



Powering Business Worldwide

TRIPP LITE  
SERIES

FEATURES & SPECIFICATIONS	
High Availability PDU Features	Remote Network Notifications
STANDARDS & COMPLIANCE	
Product Certifications	CAN/CSA-C22.2 No. 60950-1 (Canada); NOM (Mexico); UL 60950-1
Product Compliance	RoHS; FCC Part 15 Class A (USA); Trade Agreements Act (TAA)
WARRANTY & SUPPORT	
Product Warranty Period (Worldwide)	2-year limited warranty

1000 Eaton Boulevard  
Cleveland, OH 44122  
United States  
<https://tripplite.eaton.com>

© 2026 Eaton. All Rights Reserved.  
Eaton is a registered trademark. All other trademarks  
are the property of their respective owners.