

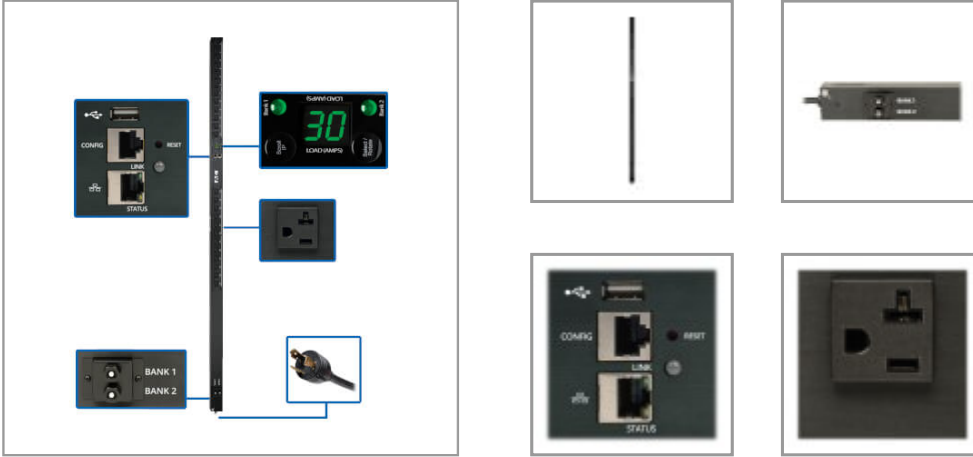

Powering Business Worldwide

## 2.9kW Single-Phase Monitored PDU with LX Platform Interface, 120V Outlets (24 5-15/20R), L5-30P Plug, 0U Vertical, TAA

MODEL NUMBER: PDUMNV30LX



2.9kW vertical PDU distributes and monitors single-phase power in an IT or industrial environment. Built-in Java-free network interface helps you remotely monitor load levels to prevent overloads that cause downtime.

### Description

The PDUMNV30LX 2.9kW Single-Phase Monitored PDU provides real-time remote monitoring of voltage, frequency and load levels via built-in network connection. Recommended for IT and industrial applications, the vertical PDU features 24 NEMA 5-15/20R outlets with included cord retention brackets to prevent cables from becoming accidentally disconnected. A 10-ft. (3.05 m) cord with NEMA L5-30P plug connects the PDU to a compatible AC power source, generator or protected UPS.

The built-in Java-free HTML5-based LX Platform network interface enables full remote access for PDU status monitoring and email notifications via secure web browser, SNMP, telnet or SSH. It supports 10/100 Mbps auto-sensing for optimum communication with an Ethernet network. Optional EnviroSense2 modules (sold separately) provide a variety of environmental monitoring capabilities. Protocols supported include IPv4, IPv6, HTTP, HTTPS, SMTP, SNMPv1, SNMPv2, SNMPv3, telnet, SSH, FTP, DHCP and NTP.

A digital ammeter allows you to monitor power consumption for both breakered load banks, as well as the total load to ensure they remain well below maximum capacity with no danger of overload. The PDU mounts in 0U of space in EIA-standard 19-inch racks using the included toolless mounting buttons or the included rack-mounting brackets. Use the included PDUMVROTATEBRKT kit to install the unit with outlets facing the rear for better airflow or equipment access.

### Features

#### Distributes and Monitors Network-Grade AC Power

- 2.9kW 120V 24A monitored rack PDU (rPDU) with single-phase input
- NEMA L5-30P with 10-ft. (3.05 m) cord connects to compatible AC power source
- Firmware upgrades support future product enhancements

#### 24 NEMA 5-15/20R Outlets Distribute Power

- Cord retention brackets prevent cables from becoming accidentally disconnected

#### Digital Ammeter

- Reports power consumption for both breakered load banks, plus total output current

### Highlights

- 2.9kW 120V single-phase monitored 0U PDU
- 24 NEMA 5-15/20R outlets with cord retention brackets
- Pre-installed WEBCARDLX with latest version of PADM20 for enhanced remote management
- Digital ammeter for on-site load monitoring in real time
- NEMA L5-30P input with 10-ft. (3.05 m) AC power cord

### Package Includes

- PDUMNV30LX 2.9kW Single-Phase Monitored PDU
- Built-in LX Platform interface
- Configuration cable
- (24) Cable ties
- (2) Cord retention brackets
- Rack-mounting hardware
- PDUMVROTATEBRKT mounting bracket accessory
- Owner's manual



Powering Business Worldwide

- Supports IP-address self-ID
- Rotates 180° for easy reading at either angle

**Built-In LX Platform Interface**

- Pre-installed WEBCARDLX with the latest version of PowerAlert Device Manager firmware (PADM20) provides enhanced remote management capabilities
- PADM20 and PowerAlert Element Manager (PAEM) form a powerful tool for expanding maintenance functions in large installations, including firmware update checks and backup and restoration of device configurations
- Supports 10/100 Mbps auto-sensing for communication with an Ethernet network
- Optional EnviroSense2 modules (sold separately) provide a variety of environmental monitoring capabilities
- No Java required

**Broad Communications Compatibility**

- Supports IPv4, IPv6, HTTP, HTTPS, SMTP, SNMPv1, SNMPv2, SNMPv3, telnet, SSH, FTP, DHCP and NTP
- Supports automatic and manual assignment of IP address

**Easy 0U Installation in EIA-Standard 19 in. Racks**

- Mounts vertically using included toolless buttons or rack-mounting brackets
- Included PDUMVROTATEBRKT allows mounting with rear-facing outlets

**TAA-Compliant**

- Compliant with the Federal Trade Agreements Act (TAA) for GSA Schedule purchases

## Specifications

OVERVIEW	
UPC Code	037332203359
PDU Type	Monitored
INPUT	
Input Phase	Single-Phase
PDU Input Voltage	120
Recommended Electrical Service	Single-phase 30A 120V service
Maximum Input Amps	24
Maximum Input Amps Details	Agency de-rated to 24A continuous
PDU Plug Type	NEMA L5-30P
Input Cord Length (ft.)	10
Input Cord Length (m)	3.05
OUTPUT	



Powering Business Worldwide

Output Capacity Details	2.88kW (120V) / 24A total capacity; 20A max per breakered load bank; 16A max per outlet
Frequency Compatibility	50 / 60 Hz
Output Receptacles	(24) 5-15/20R
Output Nominal Voltage	120V
Overload Protection	Two 20A breakers protect 12 outlets each
<b>USER INTERFACE, ALERTS &amp; CONTROLS</b>	
Front Panel LCD Display	Digital meter reports PDU output current in amps, Scroll IP-address information; Display can be rotated 180 degrees for installation with the input cable at the top
Switches	Press the SCROLL IP button and release to display the configured IP address in 2 digit intervals; Press the SELECT / ROTATE button and release after one second to advance the local display power consumption for the 3 reported segments: Bank 1, Bank 2 and Banks 1+2; Press the SELECT / ROTATE button and release after two seconds to rotate the display 180 degrees
LED Indicators	Front panel LEDs indicate which loading segment the digital LCD current display is reporting; Bank 1 LED indicates the meter is reporting load level for outlets 1-12; Bank 2 LED indicates the meter is reporting load level for outlets 13-24; Both LEDs lighted indicates the meter is reporting load level for all outlets combined
Current Measurement Accuracy (Amps)	+/-1%
Voltage Measurement Accuracy (Volts)	+/-1%
Power Measurement Accuracy (Watts)	+/-1%
<b>SURGE / NOISE SUPPRESSION</b>	
Automatic Shut-Off	No
<b>PHYSICAL</b>	
Material of Construction	Metal
Rack Height	0U
Form Factors Supported	0U vertical rackmount installation supported with included mounting brackets; supports toolless mounting in button-mount compatible racks
PDU Form Factor	Vertical (0U)
Shipping Dimensions (hwd / in.)	5.00 x 6.30 x 73.10
Shipping Dimensions (hwd / cm)	12.70 x 16.00 x 185.67
Shipping Weight (lbs.)	13.60
Shipping Weight (kg)	6.17
Unit Dimensions (hwd / in.)	70.000 x 2.190 x 1.750
Unit Dimensions (hwd / cm)	177.8 x 5.56 x 4.45
Unit Weight (lbs.)	11.5
Unit Weight (kg)	5.22
<b>ENVIRONMENTAL</b>	
Operating Temperature Range	32° to 104°F (0° to 40°C)



Powering Business Worldwide

Storage Temperature Range	-22° to 140°F (-30° to 60°C)
Relative Humidity	5% to 95% non-condensing
Operating Elevation	0-10000 ft. (0-3000 m)
<b>COMMUNICATIONS</b>	
PowerAlert Software	LX Platform Interface: PowerAlert Device Manager
Communications Cable	RJ45-to-DB9 configuration/console Access cable
SNMP Compatibility	Pre-installed LX platform interface provides remote monitoring via Java-free HTML5 web interface, telnet, SSH and SNMP management systems
Network Compatibility	10 Mbps; 100 Mbps (Fast Ethernet)
<b>FEATURES &amp; SPECIFICATIONS</b>	
High Availability PDU Features	Remote Network Notifications
<b>STANDARDS &amp; COMPLIANCE</b>	
Product Certifications	CAN/CSA-C22.2 No. 60950-1 (Canada); NOM (Mexico); UL 60950-1
Product Compliance	RoHS; FCC Part 15 Class A (USA); Trade Agreements Act (TAA)
<b>WARRANTY &amp; SUPPORT</b>	
Product Warranty Period (Worldwide)	2-year limited warranty

1000 Eaton Boulevard  
Cleveland, OH 44122  
United States  
<https://tripplite.eaton.com>

© 2026 Eaton. All Rights Reserved.  
Eaton is a registered trademark. All other trademarks  
are the property of their respective owners.