



LNX Series

Mobile Printers

Quick Start Guide

Agency Models

LNK3-0, LNK3-1

Out of the Box

Make sure your shipping box contains the following:

- LNK printer
- Power adapter
- USB cable
- Media

If you ordered accessories for your printer, verify that they are also included with the order. Be sure to keep the original packaging in case you need to return the printer for service.

Features

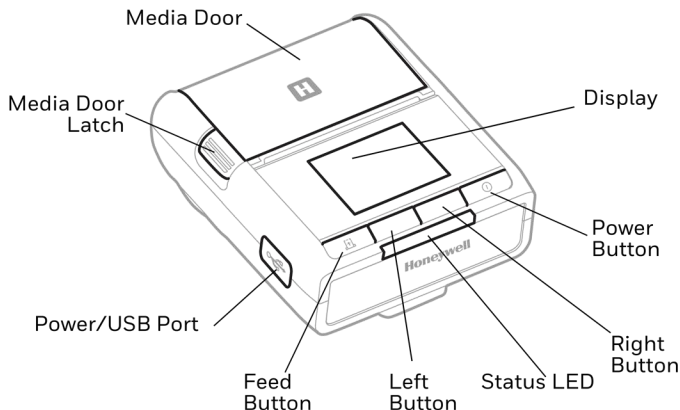

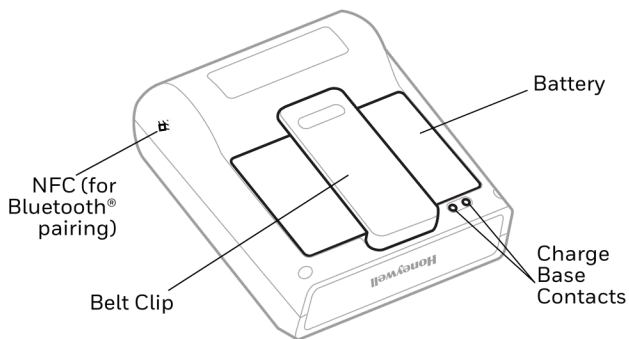

Get Started



Before you attempt to use, charge or replace the battery in the device, carefully read all labels, markings and product documentation provided in the box or online at sps.honeywell.com. To learn more about Battery Maintenance for Portable Devices, go to honeywell.com/PSS-BatteryMaintenance.

Avant d'essayer d'utiliser, de charger ou de remplacer la batterie de l'appareil, lisez attentivement toutes les étiquettes, marquages et documentation du produit fournis dans la boîte ou en ligne à sps.honeywell.com.

Pour en savoir plus sur l'Entretien de Batteries pour Appareils Portables, consultez-le honeywell.com/PSS-BatteryMaintenance.



We recommend use of Honeywell Li-ion battery packs. Use of any non-Honeywell battery may result in damage not covered by the warranty.

Nous recommandons l'utilisation de batteries Li-ion de la marque Honeywell. L'utilisation d'une batterie d'un autre fabricant est susceptible de provoquer des dommages non couverts par la garantie.



Ensure all components are dry prior to placing the battery in the device. Mating wet components may cause damage not covered by the warranty.

Assurez-vous que tous les composants sont secs avant d'insérer la batterie dans l'appareil. L'insertion de composants humides risque de provoquer des dommages non couverts par la garantie.

1.

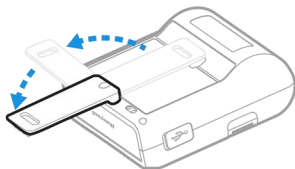

2.

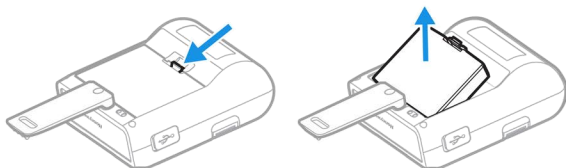

3. Remove the protective film from the battery contacts.

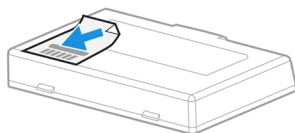

Battery

- 4.

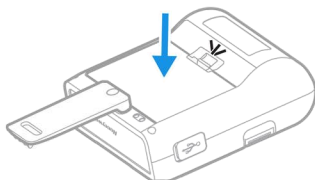
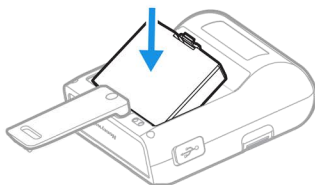

- 5.

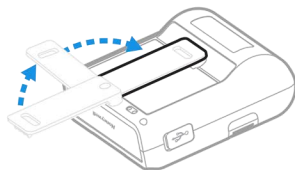

6.

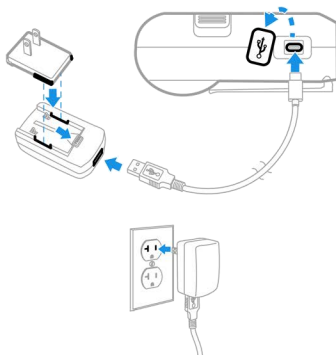

Note: Use only Honeywell-approved power supply with an output rated at 5 VDC and 2A or greater.

Battery Replacement



Do not remove battery while printer is being charged.

Hot Swap

You can replace the battery on demand provided the following condition is met:

- Printer is not being charged.
- You insert a new battery within 60 seconds.

Load Media

1.

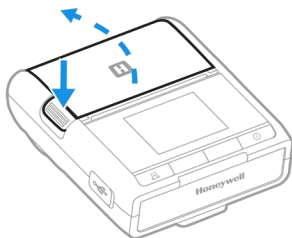

2.

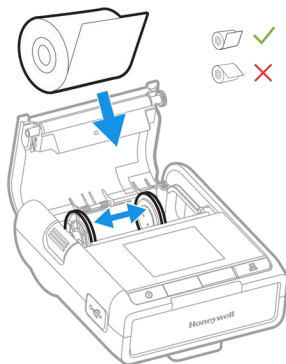

3.

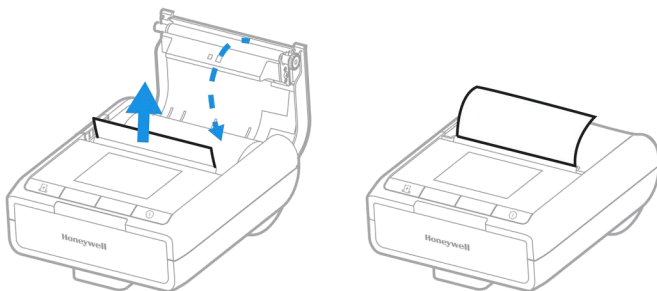



Download Required Software











Download and install the Windows® printer driver from the Technical Support Downloads Portal at honeywell.com/PSSsoftware-downloads.





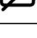
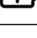
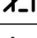





Buttons

Button	Action	Result
(any)	Short press (when printer is in Sleep mode)	Wake printer and activate display.







Button	Action	Result
 Power	Press (when printer is off)	Turn printer on.
	Long press (when printer is on)	Turn printer off.
	Short press (when display is active)	Result is determined by the icon on the user display (refer to the Display Icons table).
 Feed	Press (when display is idle)	Feed label or paper length.
	Press (when display is active)	Result is determined by the icon on the user display (refer to the Display Icons table).
Left	Press (when display is active)	Open the main menu, or move between menu options and settings.
Right	Press (when display is active)	Move between menu options and settings.

Display Icons

Icon	Description
	Power
	Media feed
	Menu
	Battery charge level
	Battery charging
	Battery less than 20%
	Out of battery
	About to shut down
	No media
	Left/Right
	Up/Down
	Back
	Edit

Icon	Description
	Add
	Minus
	Confirm
	Cancel
	Printing in progress
	Bluetooth connected
	Wi-Fi connected
	Media door open
	Overheat warning
	Seam calibration error
	Learn error

SubMenu Icons

Menu Options	Press to:
 Print Settings	View or change printer settings, such as paper width, darkness, media type, print speed and command set.
 Device Config	Set sleep mode, password, and other settings as well as restore factory defaults.
 Bluetooth	View Bluetooth information.
 WiFi	View Wi-Fi connection information.
 About	View the printer's serial number, firmware version, print mileage, and battery voltage.
 Self Test Page	Print a self-test page.

To learn more about menu options, see the user guide.

Status Indicator

State	Description
Red (when display is idle)	Printer is in Sleep mode.
Red (when display is active)	Alert (for example: media door is open, media is out, the battery is low, or an error has occurred.)

Audible Indicator

Beeps	Description
2 short beeps	Event notification (for example: printer has been turned on, battery charge is complete, firmware update is complete, media door is open, media is out, battery is low, or an error has occurred.)

Trademarks

Bluetooth trademarks are owned by Bluetooth SIG, Inc., U.S.A. and licensed to Honeywell.

Windows is a trademark of the Microsoft group of companies.

Other product names or marks mentioned in this document may be trademarks of other companies and are the property of their respective owners.

Disclaimer

Honeywell International Inc. (“HII”) reserves the right to make changes in specifications and other information contained in this document without prior notice, and the reader should in all cases consult HII to determine whether any such changes have been made. HII makes no representation or warranties regarding the information provided in this publication.

HII shall not be liable for technical or editorial errors or omissions contained herein; nor for incidental or consequential damages resulting from the furnishing, performance, or use of this material. HII disclaims all responsibility for the selection and use of software and/or hardware to achieve intended results.

This document contains proprietary information that is protected by copyright. All rights are reserved. No part of this document may be photocopied, reproduced, or translated into another language without the prior written consent of HII.

Copyright © 2023 Honeywell Group of Companies. All rights reserved.



atlas**RFID**store

(205) 383-2244

sales@atlasRFIDstore.com

www.atlasRFIDstore.com