

# Set Up Printer for Installing Board/Accessories

You need to remove both the media cover and the electronics cover to install the interface boards or accessories.

You will require the below tools to remove the media and electronics cover.

- #T20 Torx Screwdriver
- Small wrench.



**Caution: Before you begin, turn off the printer and disconnect the power cord and communication cables.**

## Remove Media Cover

To remove the media cover for PM45 printer,

1. Open the media cover.

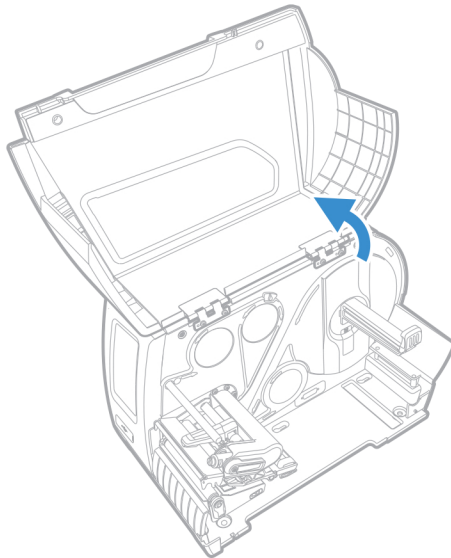

2. Use the screwdriver and rotate counterclockwise to remove the four torx screws that secures the media cover in place.

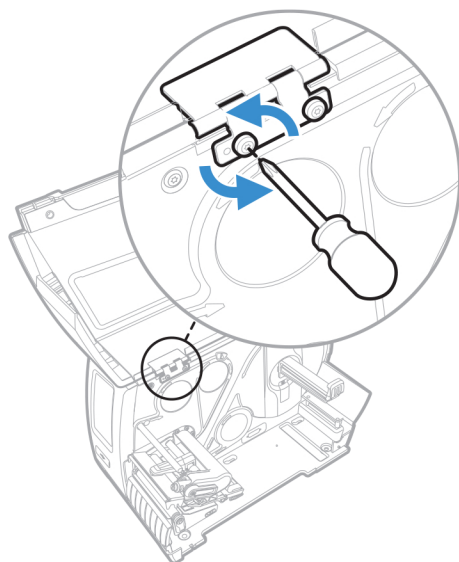

3. Lower the media cover and lift it off the hinges.
4. Put the media cover aside on a soft cloth to avoid scratches.

To remove media cover for PM45c printer,

1. Open the media cover.
2. Use a small wrench to loosen the nut that secures the media cover latches in place.
3. Slide the latches counterclockwise into the open position.

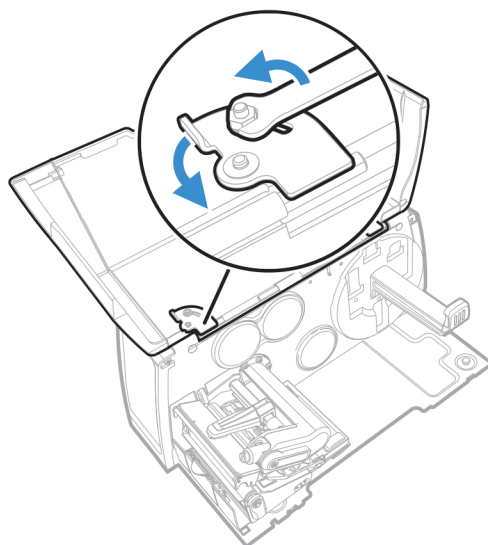

4. Close the media cover and lift it off the hinges.

## Remove Electronics Cover

To remove the electronics cover,

1. Remove the media cover.
2. Use a T20 Torx screwdriver to remove the two screws that secure the electronics cover to the inside of the printer base.

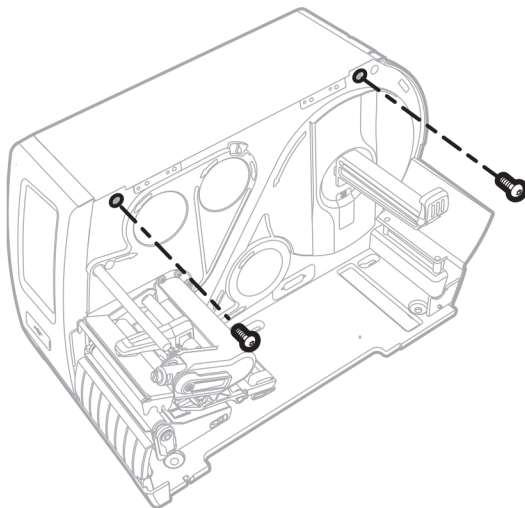

3. Use a T20 Torx screwdriver to remove the two screws located on the outside of the electronics cover.

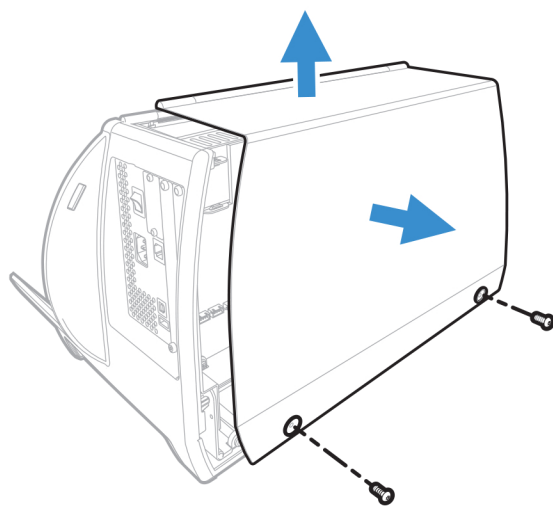

4. Remove the electronics cover, and put the cover aside on a soft cloth to avoid scratches.

## Remove Front Access Door

To remove the access door for PM45 printer,

1. Open the access door and lift it out and away from the printer.

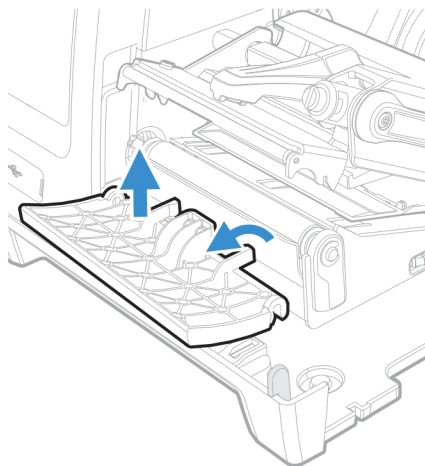

To remove the access door for PM45c printer,

1. Open the access door, remove the T20 screw that attaches it to the printer and slide it out and away from the printer.

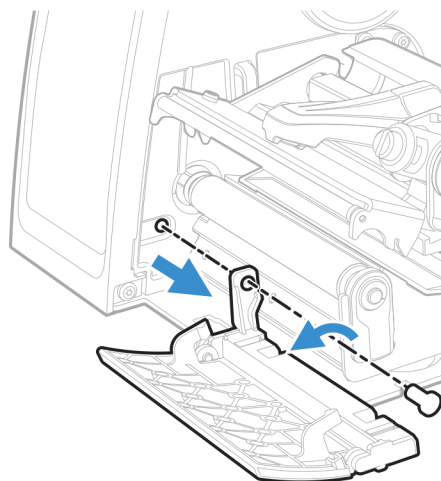

For more information about available accessories, see the PM45 product page at [www.sps.honeywell.com](http://www.sps.honeywell.com). Contact your local sales representative for ordering information.

# Cutter Module

Cutter modules for PM45 and PM45c come with standard cutter module for non adhesive labels and a cutter with adhesive resistant blades for adhesive labels.

The installation procedure is same for both models of cutter.

## Installing Cutter Module for PM45 Printer

Use these instructions to install the cutter in the PM45 printer. You will find the following items in the shipping box.

- Standard Cutter module with bracket
- 4 Torx screws and 4 washers

You will need a Torx screwdriver to install the cutter module.



**Warning: The cutter must only be installed by an authorized service technician.**



**Caution: Follow standard ESD guidelines to avoid damaging the equipment you are servicing.**



**Caution: Before you begin, turn off the printer and disconnect the power cord and communication cables.**

To install the standard cutter module,

1. Remove the media cover.
2. Remove the front access door.

3. Remove the three screws that attach the tear bar to the printer and remove it.

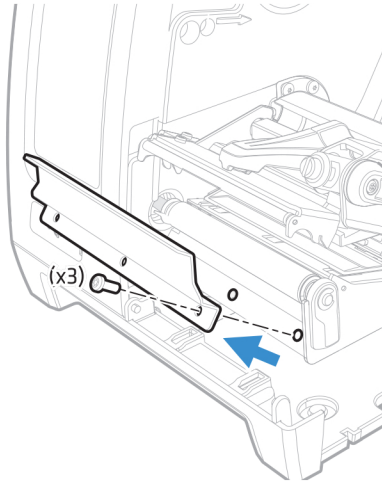

4. Carefully turn the printer on its side and align the cutter bracket with the holes in the base of the printer.

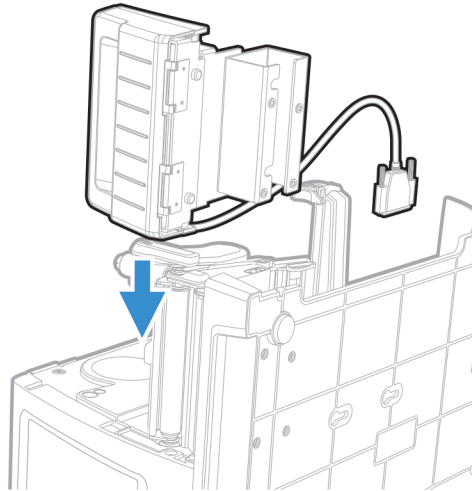

5. Attach the cutter bracket to the printer base with the four Torx screws and washers.

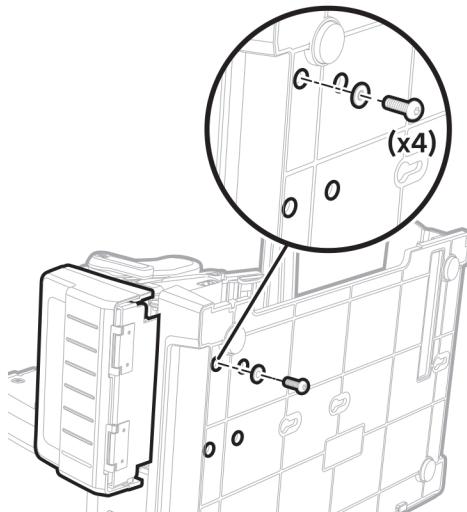

6. Turn the printer back upright and connect the cutter cable on the electronics side of the printer.

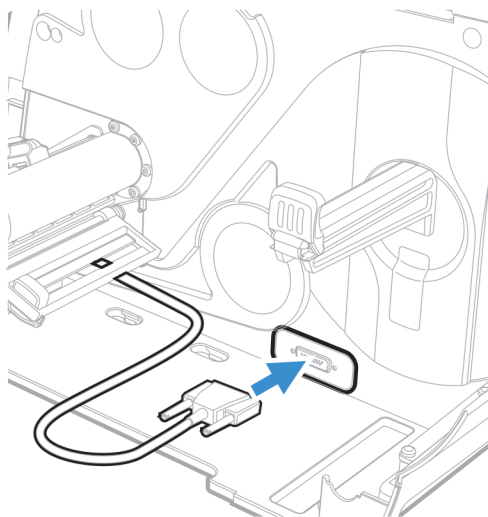

7. Route the media through the printer and out through the cutter.

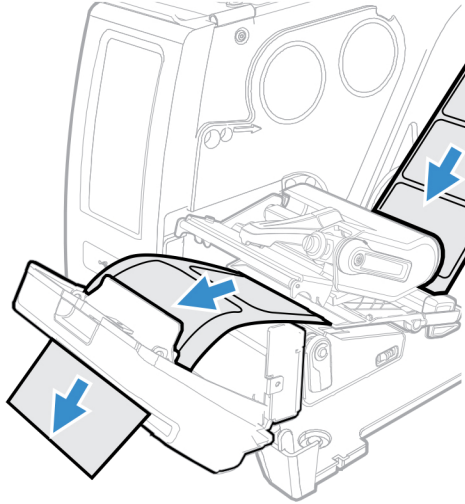

8. Close the printhead and close the media cover.

