



# T4000 Compact Thermal/RFID Printer

Productivity • Adaptability • Dependability

## Small, Fast and Ready to Boost Productivity

The T4000 light industrial printer series is our most compact and affordable industrial printer with the ability to print 5,000 labels a day at speeds of up to 10-inches per second. If you are looking to improve productivity – look no further. The T4000 includes RFID capability, Printronix System Architecture (PSA), multiple connectivity options, and remote printer management tools and automated alerts to keep your enterprise operating at optimum efficiency and productivity.

RFID upgrade kits are available for the T4000 standard model to provide customers a cost-effective solution to integrate RFID technology into their operation without the upfront investment.

## Product Benefits

- High performance ARM Cortex-A7
- 128MB RAM / 128MB Flash Memory
- Four-inch print width
- Available in 203dpi or 300dpi
- Steel frame enclosure w/ bifold media door
- Supports all major thermal printer languages
- Transfer and direct printing
- Color 3.5in LCD nine-key control panel
- Standard Ethernet, USB, and serial interfaces
- Optional Wi-Fi 802.11a/b/g/n/ac and MFi Bluetooth 5.0
- Enterprise level Ethernet and Wi-Fi security
- Optional RFID Encoder/Antenna System
- 4-32 GB SD memory card capability
- Premium Asian and Andale font support



## Enterprise Level Productivity

- Industry-leading print speed of 10 ips
- Easily prints 5,000 labels a day in demanding environments
- Compatible with PrintNet Enterprise, printer management tool
- Fast ARM Cortex A-7 processor
- Automated alerts keep your enterprise efficient and productive
- Uptime is maximized with 450m ribbons and 8" label roll capacity



## Adaptable Features

- Extensive standard connectivity: Ethernet, USB Host, USB device, serial
- RFID print/encode for standard smart labels, on-metal tags and many other tag constructions
- Optional connectivity: Enterprise level WiFi 802.11a/b/ g/n/ac, MFi Bluetooth 5.0
- Enterprise level WiFi encryption and security protocols
- Nine printer emulations for seamless integrations
- Compact size makes it a good fit for multiple industries
- Upgrade kits available with tear and cutter (media handling)



## Dependable Design

- Rugged metal enclosure with bifold side panel
- Built on Printronix System Architecture (PSA) platform for proven dependability
- Proprietary printhead algorithms deliver high-quality barcodes
- Large LCD color screen and easy-to-use control panel
- High MTBF of up to 12,000 hrs
- Wide operating temperature range from 0°C to 40°C

## Key Features

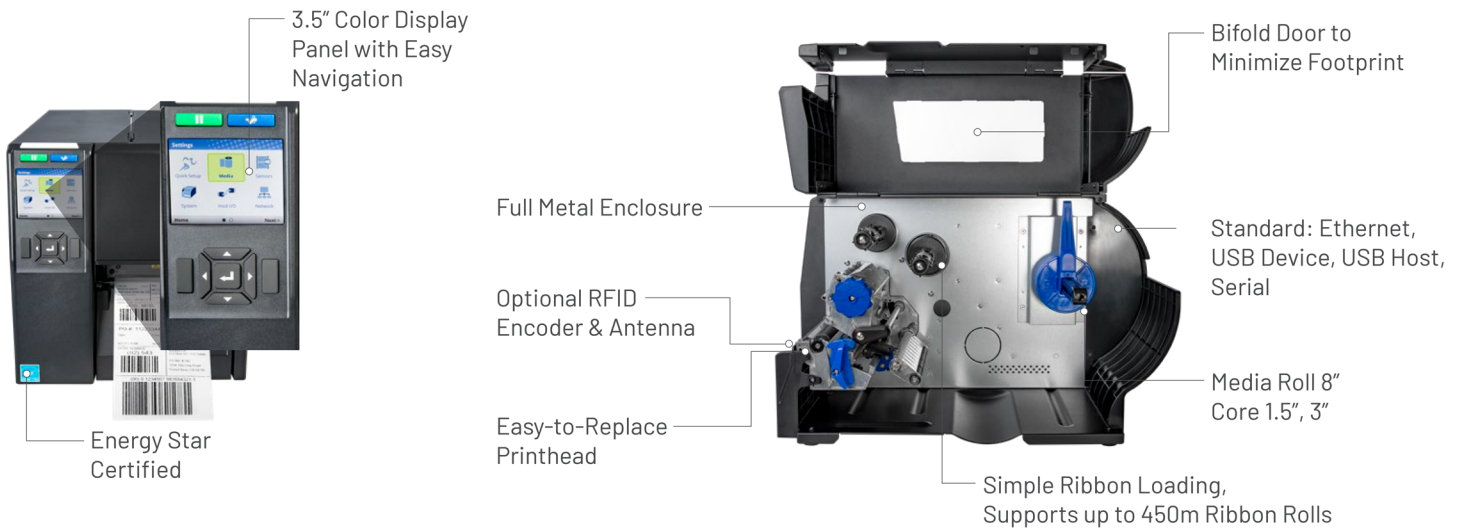

### Enterprise Level Productivity

PSA is an intelligent design platform that combines advanced features with a common set of building blocks to simplify printer installation, operation, and improve productivity.

- The printer includes the tools to install, configure and troubleshoot multiple printers at once.
- Printers are fast and reliable for maximum productivity.
- The time required to perform day-to-day tasks has been minimized.
- Includes multiple connectivity options and advanced security protocols.



### The T4000 RAIN (GS1 EPC Gen2 v2 / ISO 18000-63) system offers several advanced features.

- Encodes and prints on standard RFID paper labels most commonly used in carton or pallet supply chain applications
- Encodes and prints on-metal tags
- Encodes and prints many other tag constructions such as, Returnable Transport Item tags, Electrostatic Discharge tags, and many more
- Validates encoding process, and automatically overstrikes and reprints any RFID label (or tag) that fails to encode properly
- Records all RFID labels for encoding process, tracks success/failure rates



#### Ease of Installation

- Drop-in installation with minimal setup & multiple emulations
- Easy to configure control panel or with interactive webpage
- Full suite of connectivity options & security protocols



#### Ease of Maintenance

- Remotely troubleshoot & monitor printer status
- Push firmware & re-configure printers in batches
- Easy printer swap with quick change memory card (QCMC)
- Commonality of operation between all Printronix Auto ID printers



#### Reliable Label Production

- Easy to use large color LCD display with intuitive icon-driven menu
- Fast print speed and time-to-firstprint
- More uptime with easy load media and large ribbon rolls
- Dependable production up to 5,000 labels per day

# T4000 | Data Sheet

Model	T4000
<b>Resolution</b>	203dpi or 300dpi
<b>Printing method</b>	Direct Thermal and Transfer Thermal
<b>Max. print speed</b>	10ips @ 203dpi, 7ips @ 300dpi
<b>Max. print width</b>	4.1" (104mm)
<b>Media type</b>	Roll or Fan-Fold Labels, Tags, Paper, Film, Tickets
<b>Media handling</b>	Standard: Continuous, Tear-Off Options: Peel/Rewind (paper labels, 6ips, rewinds liner from 8 in roll) Cutter (thickness as per media spec, life 500,000 cuts) (Does not support on-metal RFID labels/tags)
<b>Media width</b>	Min 1" (25.4mm) / Max 4.72" (120mm)
<b>Media thickness</b>	0.002" (0.06mm) to 0.011" (0.279mm) / RFID Max thickness 0.05" (1.2mm)
<b>Media length</b>	Min.: Continuous, Tear-Off 0.25" (6.35mm) Min.: Peel-Off, Cutter 1.0" (25.4mm) Max.: 50" (1,270mm)
<b>Media core diameter</b>	1.5" (38.1mm) - 3.0" (76.2mm)
<b>Media max. roll diameter</b>	8.0" (209mm)
<b>Ribbon type</b>	Wax, Wax/Resin, Resin
<b>Ribbon width</b>	Min 1.6" (40mm) / Max 4.33" (110mm)
<b>Ribbon length</b>	1476.4 ft (450m)
<b>Ribbon core diameter</b>	1.0" (25.4mm)
<b>Interface I/O</b>	Standard: Serial RS232, USB, and Ethernet 10/100Base T / Optional: Wi-Fi 802.11a/b/g/n/ac, MFi Bluetooth 5.0
<b>WiFi security encryption</b>	WEP 40/128bit, WPA Personal (PSK), WPA2 Personal (PSK), Enterprise (AES CCMP)
<b>WiFi security authentication</b>	EAP-TLS, EAP-TTLS, PEAPv0/MS-CHAPv2, PEAPv1, EAP-MDS, LEAP
<b>Remote management software</b>	PrintNet Enterprise Suite, SOTI Connect: IoT device management
<b>Memory</b>	128 MB Flash / 128 MB DDR
<b>Line input</b>	Auto Range 100 - 240 VAC (48 - 62 Hz)
<b>Fonts</b>	Font Technologies: Intellifont, TrueType, Unicode Standard Fonts: OCRA, OCRB, Courier, Letter Gothic, CG Times, CG Triumvirate/Bold/Condensed Premium Asian Fonts (Optional SD card): Simplified Chinese, Japanese, Korean, Thai Andale Asian Fonts (Optional SD card): Simplified Chinese, Traditional Chinese, Korean, Japanese PDF/ PostScript Level 3: 35 fonts
<b>Graphic formats</b>	PCX, TIFF, BMP, PNG
<b>Barcode</b>	1D barcode: BC-412, Code 11, Code 39, Code 35, Code 93, Codabar, Code128 Subsets A/B/C, Industrial 2 of 5, Interleave 2 of 5, German I-2/5, EAN-8, EAN-13, UCC/EAN-128, UPC-A, UPC-E, UPCSHP, UPS 11, MSI, Matrix 2 of 5, PLESSEY, POSTNET, 4-state PostBar, Australian 4-state, FIM, ITF14, TELEPEN, PLANET, USPS Intelligent Mail, LOGMARS 2D barcode: PDF-417, MicroPDF-417, Maxicode, DataMatrix, QR Codes, Aztec, GS1 Databar (RSS-14)
<b>RFID</b>	RAIN UHF Passive (GS1 EPC Gen2 v2 / ISO 18000-63) Fixed Position Antenna Standard/On-Metal Tags/ Additional Tag Constructions Minimum Label/Tag Pitch 0.625" (15.9 mm) On-Metal Tag Thickness up to 0.05" (1.2mm) Printer languages: PGL, ZGL, STGL, MGL Counters: Tracks good/overstruck labels/tags
<b>Operating environment</b>	Operating Temperature: 32° to 104°F (0° to 40°C) (limitations based on selected media) / Operating Humidity: 25-85% Non-Condensing Storage Temperature: -40° to 140° F (-40° to 60° C) / Storage Humidity: 10 - 90% Non-Condensing
<b>Regulatory compliances</b>	Emissions: FCC, CE, IC, CCC, KC Safety: cTUVus, CE, IC, EAC, SMARK, NOM, CCC, KC, BIS, BSMI Environmental: RoHS, WEEE, Energy Star 3.0 RFID: FCC, CE, ANATEL, ICT, KC, MIC, NCC., SRRC, WPC WiFi/BT: US, Canada, European Union, China
<b>Physical dimension (W x H x D)</b>	10.40" (264mm) x 10.9" (276mm) x 17.9" (455mm)
<b>Weight</b>	22lbs (10kg)
<b>Options &amp; Accessories</b>	Wi-Fi 802.11a/b/g/n/ac MFi Bluetooth 5.0 Cutter Peel/Rewind Andale Asian Font Card Premium Asian Font Card QCMC (Quick Change Memory Card) RFID Encoder/Antenna System

